

# 10 CHANDLER

10chandler.com

## SPEC SUITE 5

BUILDING 8

460 North 54th Street  
Chandler Arizona

**12,313 TOTAL SF**

**1,120 OFFICE**

**11,193 WAREHOUSE**

### Features

- New construction
- 400 watt high bay metal halide lights
- 14,381 CFM evaporative coolers
- 553,005 square foot business park

### Rate

- \$0.66/SF/MO NNN

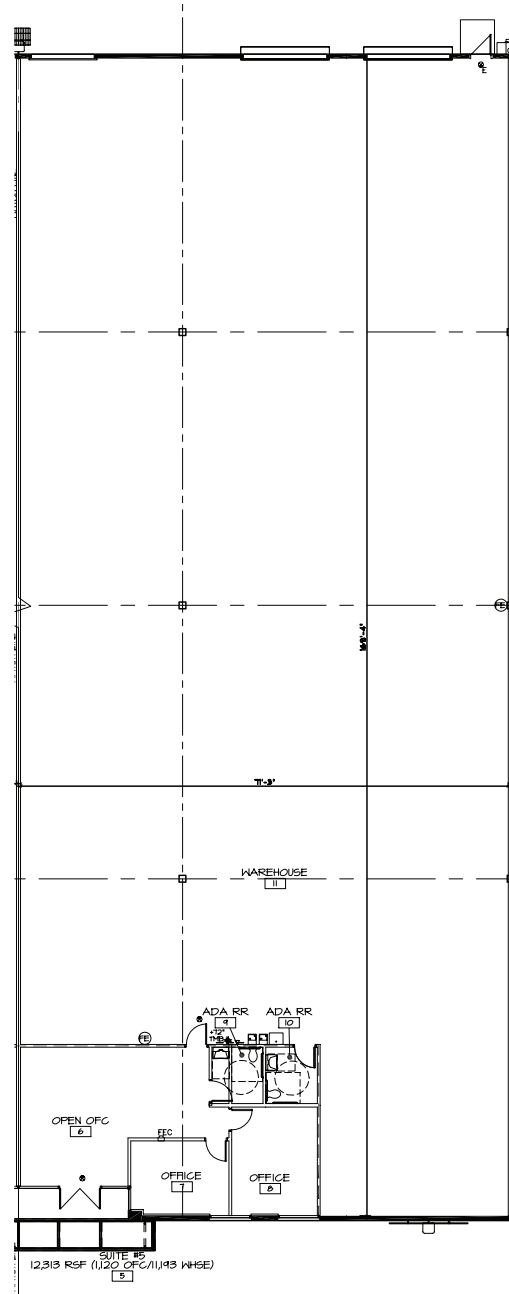

a development of

# LPC

LINCOLN PROPERTY COMPANY

**MARK DETMER, CCIM**

Executive Director

(602) 229-5971

mark.detmer@cushwake.com

**BO MILLS, SIOR, CCIM**

Executive Director

(602) 229-5970

bo.mills@cushwake.com

**MIKE KASULAITIS**

Associate Director

(602) 229-5969

mike.kasulaitis@cushwake.com

*introducing a new business park in Chandler  
with prime Interstate 10 frontage*



**CUSHMAN & WAKEFIELD**

Global Real Estate Solutions<sup>SM</sup>

available for sale or lease

# 10 CHANDLER

10chandler.com

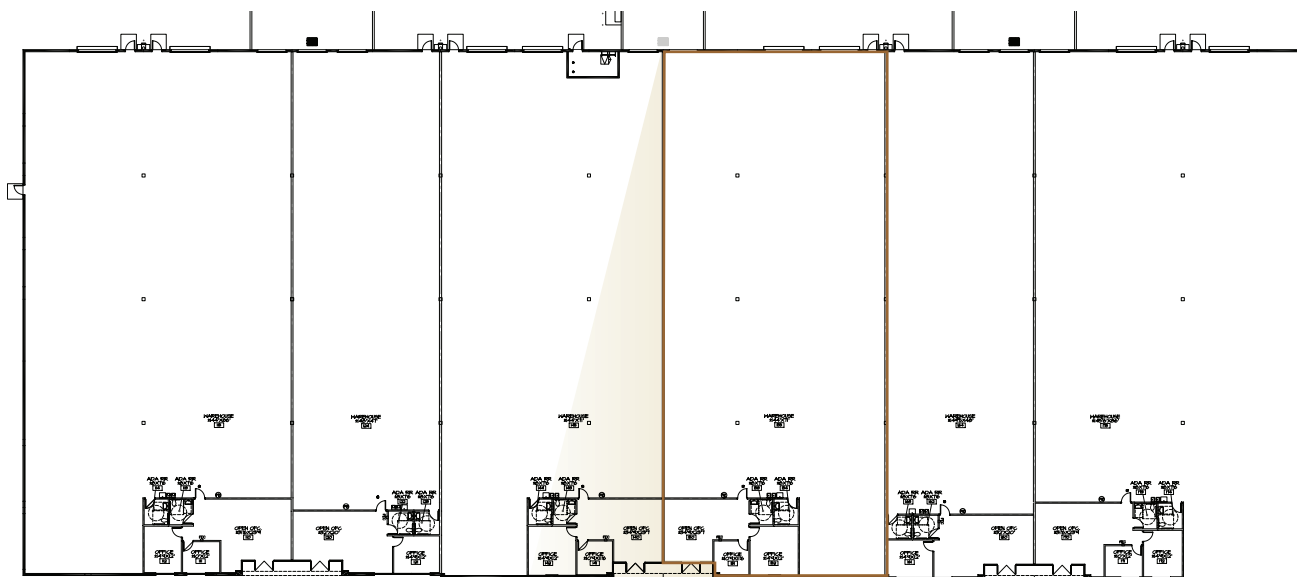

## Building 8 Spec Suite 5

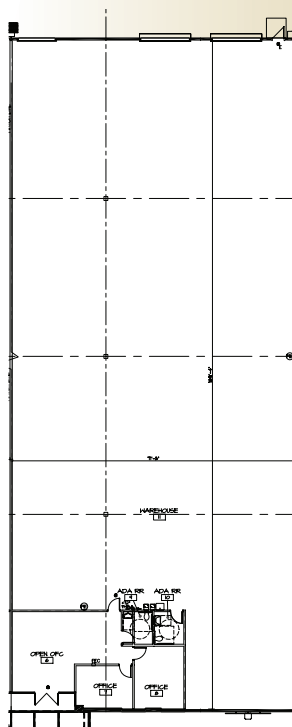

a development of

**LPC**  
LINCOLN PROPERTY COMPANY

**MARK DETMER, CCIM**  
Executive Director  
(602) 229-5971  
mark.detmer@cushwake.com

**BO MILLS, SIOR, CCIM**  
Executive Director  
(602) 229-5970  
bo.mills@cushwake.com

**MIKE KASULAITIS**  
Associate Director  
(602) 229-5969  
mike.kasulaitis@cushwake.com

*introducing a new business park in Chandler  
with prime Interstate 10 frontage*

 **CUSHMAN & WAKEFIELD**  
Global Real Estate Solutions <sup>SM</sup>