

# 10 CHANDLER

10chandler.com

## SPEC SUITE 8

**BUILDING 8**

**460 North 54th Street  
Chandler Arizona**

**8,178 TOTAL SF**

**1,008 OFFICE**

**7,170 WAREHOUSE**

### Features

- New construction
- 400 watt high bay metal halide lights
- 14,381 CFM evaporative coolers
- 553,005 square foot business park

### Rate

- \$0.83/SF/MO NNN

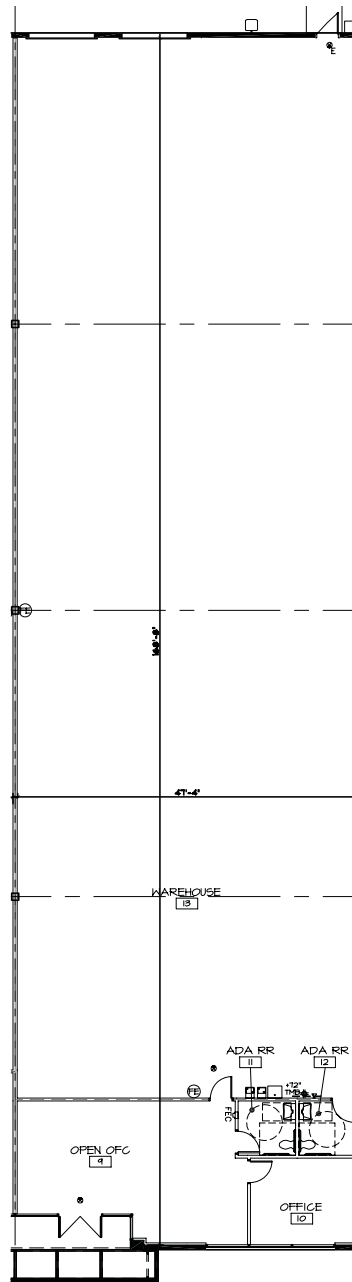

*a development of*

# LPC

LINCOLN PROPERTY COMPANY

**MARK DETMER, CCIM**

Executive Director

(602) 229-5971

mark.detmer@cushwake.com

**BO MILLS, SIOR, CCIM**

Executive Director

(602) 229-5970

bo.mills@cushwake.com

**JOHN GRADY**

Associate

(602) 229-5835

john.grady@cushwake.com

*introducing a new business park in Chandler  
with prime Interstate 10 frontage*



**CUSHMAN &  
WAKEFIELD**

Global Real Estate Solutions <sup>SM</sup>

available for sale or lease

# 10 CHANDLER

10chandler.com



**Building 8**  
Spec Suite 8

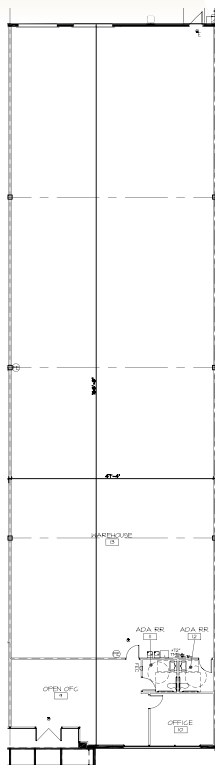

**MARK DETMER, CCIM**  
Executive Director  
(602) 229-5971  
mark.detmer@cushwake.com

**BO MILLS, SIOR, CCIM**  
Executive Director  
(602) 229-5970  
bo.mills@cushwake.com

**JOHN GRADY**  
Associate  
(602) 229-5835  
john.grady@cushwake.com

a development of

## LPC

LINCOLN PROPERTY COMPANY

*introducing a new business park in Chandler  
with prime Interstate 10 frontage*



**CUSHMAN & WAKEFIELD**  
Global Real Estate Solutions <sup>SM</sup>